

Final Report (CY 2003 Grants and Prior)
 Targeted Runoff Management Grant Program and Urban Nonpoint
 Source and Storm Water Management Grant Program

Form 3400-189P (R 11/05)

Notice: This final report is authorized by ss. 281.65 and 281.66, Wis. Stats., and chs. NR 153 and NR 155, Wis. Adm. Code. Personally identifiable information collected will be used for program administration and may be made available to requesters as required under Wisconsin's Open Records Law [ss. 19.31-19.39, Wis. Stats.].

Instructions: The grant agreement requires grantees to submit a Final Report 60 days after the end date listed in the grant agreement. This Final Report form must be used in conjunction with the "FINAL REPORT INSTRUCTIONS." The instructions detail how to complete and submit the report to DNR.

1. Grant Type

- Agricultural - Targeted Runoff Management Grant
- Urban - Targeted Runoff Management Grant
- Construction - Urban Nonpoint Source & Storm Water Management Grant
- Planning - Urban Nonpoint Source & Storm Water Management Grant

2. Grantee & Project Information

| | |
|--|--|
| Project Name Public Works Yards Best Management Practices | Grant Number USC-MI02-41251-03-03 |
| Governmental Unit Name City of Milwaukee | Governmental Unit Type (city, village, town, etc.) City |
| Watershed Name Various | Watershed Code Various |
| DNR Water Management Unit (River System) Name Various | Water Body Identification Code (WBIC) (if applicable) Various |

s. 303(d) Waterbody? Yes No

What pollutant(s) were addressed by the project?

Sediment from vehicles; PAH; spills from refueling vehicles

For each project site location provide the following: (attach additional sheets if necessary)

| Location: | | A | B | C | D | E |
|---|-----------------|---------------------------------|---------------------------------|---|---|---|
| Minor Civil Division Name | | City of Milwaukee | City of Milwaukee | | | |
| PLSS | Town | 7 | 6 | | | |
| | Range | 22 | 21 | | | |
| | Section | 30 | 12 | | | |
| | Quarter | 4 | 2 | | | |
| | Quarter-Quarter | 4 | 1 | | | |
| Latitude | | 87°55'48.3"W | 87°57'44.8"W | | | |
| Longitude | | 43°1'59.8"N | 43°0'7.8"N | | | |
| Property Owner(s) | Name | City of Milwaukee | City of Milwaukee | | | |
| | Mailing address | 841 N. Broadway Room 602 | 841 N. Broadway Room 602 | | | |
| Site address (if different than mailing address) | | 1313 W. Mt. Vernon Milw., WI | 1313 W. Mt. Vernon Milw., WI | | | |

*on final but you
 on w/ brush
 2 copies would*

*apparently not
 location added to date form 2/12/06 RJJ*

3. Summary of Results

A. Performance Standards and Prohibitions and Other Water Resources Management Priorities

For grants issued in calendar year 2006 or later, complete Tables A and B (following) consistent with the entries on your grant application. For grants issued prior to calendar year 2006, complete Tables A and B, *to the best of your knowledge*, consistent with the entries on your grant application.

Table A. Performance Standards and Prohibitions (per ch. NR 151, Wis. Adm. Code, effective October 1, 2002)

| Performance Standard or Prohibition | Units of Measure | Quantity | Measurement Method Used |
|---|---------------------------------|----------|-------------------------|
| Sheet, rill and wind erosion | Acres meeting T | | |
| Manure Storage Facilities: New Construction/Alterations | Number of facilities | | |
| | Number of animal units | | |
| Manure Storage Facilities: Closure | Number of facilities | | |
| Manure Storage Facilities: Failing/Leaking Facilities | Number of facilities | | |
| | Number of animal units | | |
| Clean Water Diversions in WQMA | Pollutant load reduction | | |
| | Number of farms with diversions | | |
| | Number animal units | | |
| Nutrient Management on Agricultural Land | Acres planned | | |
| Prohibition: Manure Storage Overflow | Number of facilities | | |
| | Number of animal units | | |
| Prohibition: Unconfined Manure Pile in WQMA | Number of farms | | |
| Prohibition: Direct Runoff From Feedlot/Stored Manure | Pollutant load reduction | | |
| | Number of facilities | | |
| | Number of animal units | | |
| Prohibition: Unlimited Livestock Access | Feet of bank protected | | |
| | Number of farms | | |
| Urban: 20-40% Reduction in Total Suspended Solids (TSS) | Pounds TSS reduced | | |
| | % TSS reduction | | |

Table B. Other Water Resources Management Priorities

| I. Agricultural Areas | Units of Measure | Quantity | Measurement Method Used |
|--|----------------------------------|----------|-------------------------|
| Buffers | Feet of bank protected | | |
| | Number of farms | | |
| Streambank | Tons of bank erosion reduced | | |
| | Feet of bank protected | | |
| Other (specify) | | | |
| II. Developed Urban Areas | Units of Measure | Quantity | Measurement Method Used |
| Urban: 20-40% Reduction in TSS | Pounds TSS reduced | | |
| | % TSS reduction | | |
| Infiltration | % Pre-development stay-on volume | | |
| | Cubic feet stay-on volume | | |
| Peak flow discharge | Change in cubic feet per second | | |
| Protective areas | Feet of bank protected | | |
| Fueling & maintenance areas | Oily sheen presence | None | Visual |
| Streambank | Tons of bank erosion reduced | | |
| | Feet of bank protected | | |
| Other (specify) | | | |
| III. Planning | Units of Measure | Quantity | Measurement Method Used |
| Quantify how implementation of the planning project decreased storm water impacts on state waters (<i>i.e.</i> , storm water plan, I & E plan, <i>etc.</i>) | Municipalities planned for | | |
| | Acres planned for | | |
| Document/track progress made in implementing the planning product (<i>i.e.</i> , ordinance, utility district evaluation/formation, storm water management plan information & education, <i>etc.</i>) | Municipalities planned for | | |
| | Acres planned for | | |
| Other (specify) | | | |

B. Project Results Narrative

Canopies were installed over refueling areas and at a self help location over waste oil and anti-freeze above ground storage tanks. Rain water does not directly impact the refueling areas.

4. Satisfaction of Notice Requirements (if applicable)

If cost sharing for this project was offered under a formal notice to achieve compliance with performance standards or prohibitions, provide information for each notice in the table below.

| Notice Information | | | | Notice Satisfaction Information | | |
|--------------------|------------|-------------|-----------|---------------------------------|--------------------------|------------------|
| Notice Type | Issue Date | From (Name) | To (Name) | Satisfied? | | Date Letter Sent |
| | | | | Yes | No | |
| N/A | | | | <input type="checkbox"/> | <input type="checkbox"/> | |
| | | | | <input type="checkbox"/> | <input type="checkbox"/> | |
| | | | | <input type="checkbox"/> | <input type="checkbox"/> | |
| | | | | <input type="checkbox"/> | <input type="checkbox"/> | |

5. Summary of Project Challenges

The projects were designed by consultant engineers and there were no problems encountered.

6. Additional Information about the Project (optional)

7. Planning Product (UNPS&SW - Planning Projects only)

Check here if a printed copy of the planning product (e.g., plans, ordinances, analyses) was sent to your DNR Regional Nonpoint Source Coordinator.

| | | |
|--|--------------------------------------|---|
| Name of Document Specifications for Self Help South & Americology | Date(s) effective 4-04 thru 12-04 | Date Submitted to NPS Coordinator 4-04 |
|--|--------------------------------------|---|

8. Grantee Certification:

Check here to certify that, to the best of your knowledge, the information contained in this report is correct and true.

| | |
|---|--------------------|
| Type or print Name and Title of Authorized Representative certifying here. Jeffrey J. Mantes, Commissioner of Public Works | Date 1-3-05 |
|---|--------------------|

Milwaukee_Cty-Public Works BMPs_ Wed Nov 08 14:55:48 CST 2006

Legend

- Railroads
- Local Roads
- NR104 Lines
- Trout Stream Lines
- Class 1
- Class 2
- Class 3
- Outstanding and Exceptional Waters
- Exceptional
- Outstanding
- WADRS TMDL Category Lines
- Contaminated Sediment Dominated
- Atmospheric Deposition Dominated
- Physical or Habitat Dominated
- Nonpoint Source Dominated
- Point and Nonpoint Source Blend
- Other or Multiple Factors
- WADRS TMDL Category Areas
- Contaminated Sediment Dominated
- Atmospheric Deposition Dominated
- Physical or Habitat Dominated
- Nonpoint Source Dominated
- Point and Nonpoint Source Blend
- Other or Multiple Factors
- WADRS TMDL Priority Lines
- High Priority - 2004
- High Priority
- Medium Priority
- Low Priority
- Low Priority - 2002
- Not Prioritized
- Multiple priorities
- WADRS TMDL Priority Areas
- High Priority - 2004
- High Priority
- Medium Priority
- Low Priority
- Low Priority - 2002
- Not Prioritized
- Multiple priorities
- WADRS 303d Flag Lines
- WADRS 303d Flag Areas
- WADRS Assessment Unit Lines
- WADRS Assessment Unit Polygons
- WBIC Areas
- WBIC Lines
- Rivers and Streams
- 24K Open Water
- PLSS Townships
- PLSS Sections

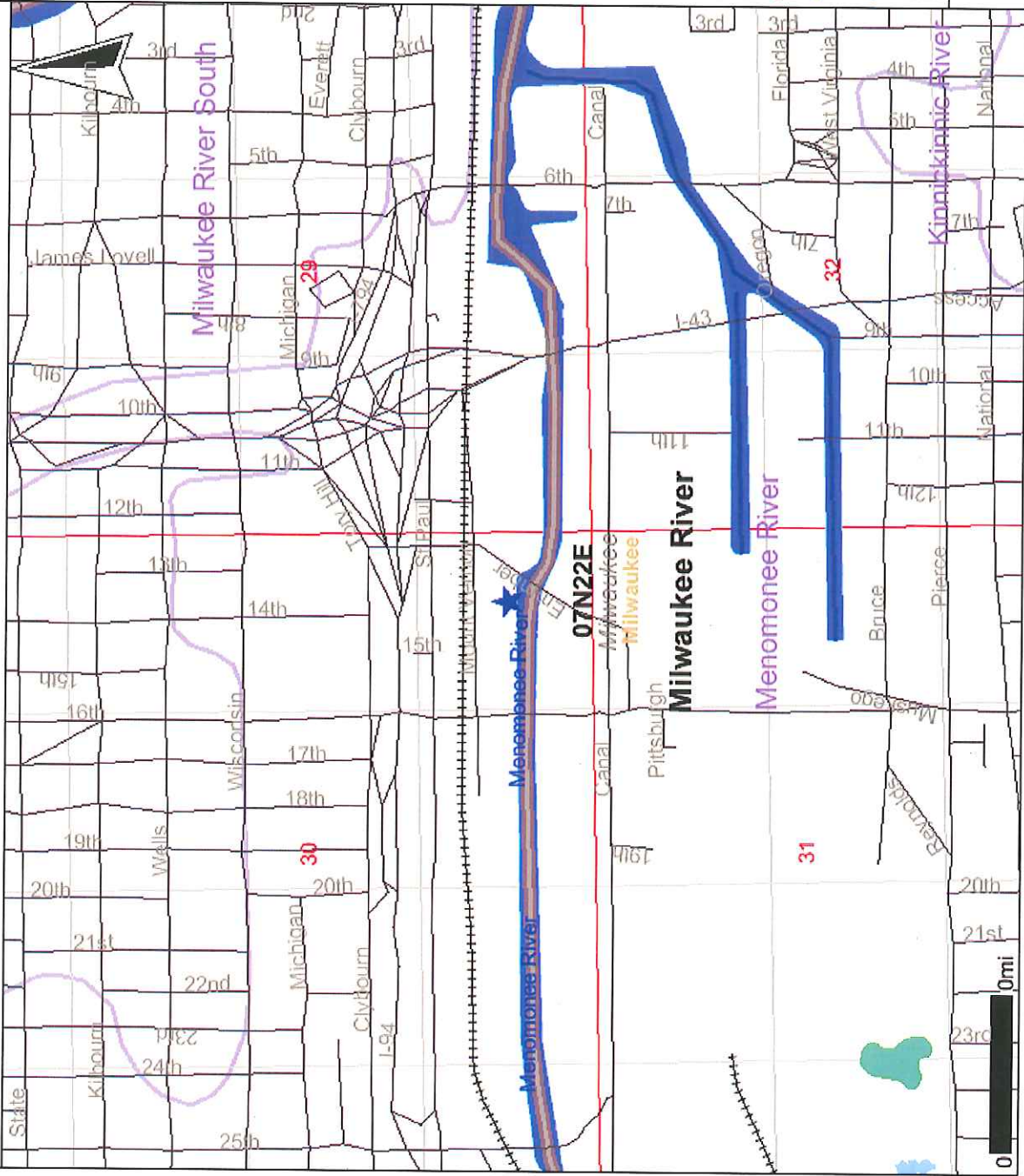

Scale: 1:14,040
DO NOT USE FOR NAVIGATION

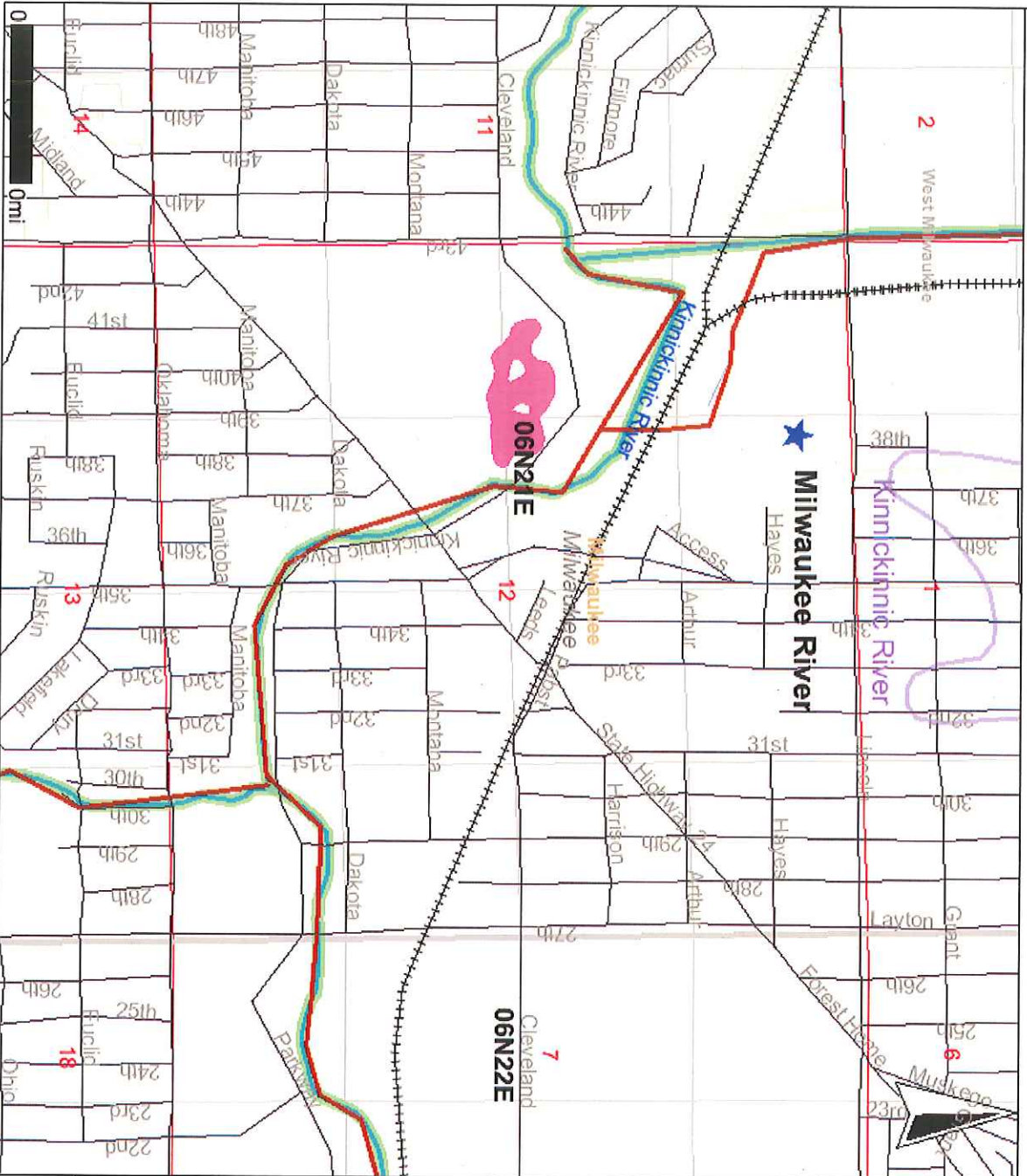

- Railroads
- Local Roads
- NR104 Lines
- Trout Stream Lines
- Class 1
- Class 2
- Class 3
- Outstanding and Exceptional Waters
- Exceptional
- Outstanding
- WAQRS TMDL Category Lines
- Contaminated Sediment Dominated
- Atmospheric Deposition Dominated
- Physical or Habitat Dominated
- Nonpoint Source Dominated
- Point and Nonpoint Source Blend
- Other or Multiple Factors
- WAQRS TMDL Category Areas
- Contaminated Sediment Dominated
- Atmospheric Deposition Dominated
- Physical or Habitat Dominated
- Nonpoint Source Dominated
- Point and Nonpoint Source Blend
- Other or Multiple Factors
- WAQRS TMDL Priority Lines
- High Priority - 2004
- High Priority
- Medium Priority
- Low Priority
- Low Priority - 2002
- Not Prioritized
- Multiple priorities
- WAQRS TMDL Priority Areas
- High Priority - 2004
- High Priority
- Medium Priority
- Low Priority
- Low Priority - 2002
- Not Prioritized
- Multiple priorities
- WAQRS 303d Flag Lines
- WAQRS 303d Flag Areas
- WAQRS Assessment Unit Lines
- WAQRS Assessment Unit Polygons
- WBIC Areas
- WBIC Lines
- Rivers and Streams
- 24K Open Water
- PLSS Townships
- PLSS Sections

Scale: 1:14,445

DO NOT USE FOR NAVIGATION



A Keep Greater Mil Beautiful Incorporated (414) 272-5462
1313 W MOUNT VERNON AVE, MILWAUKEE, WI, 53233-2620

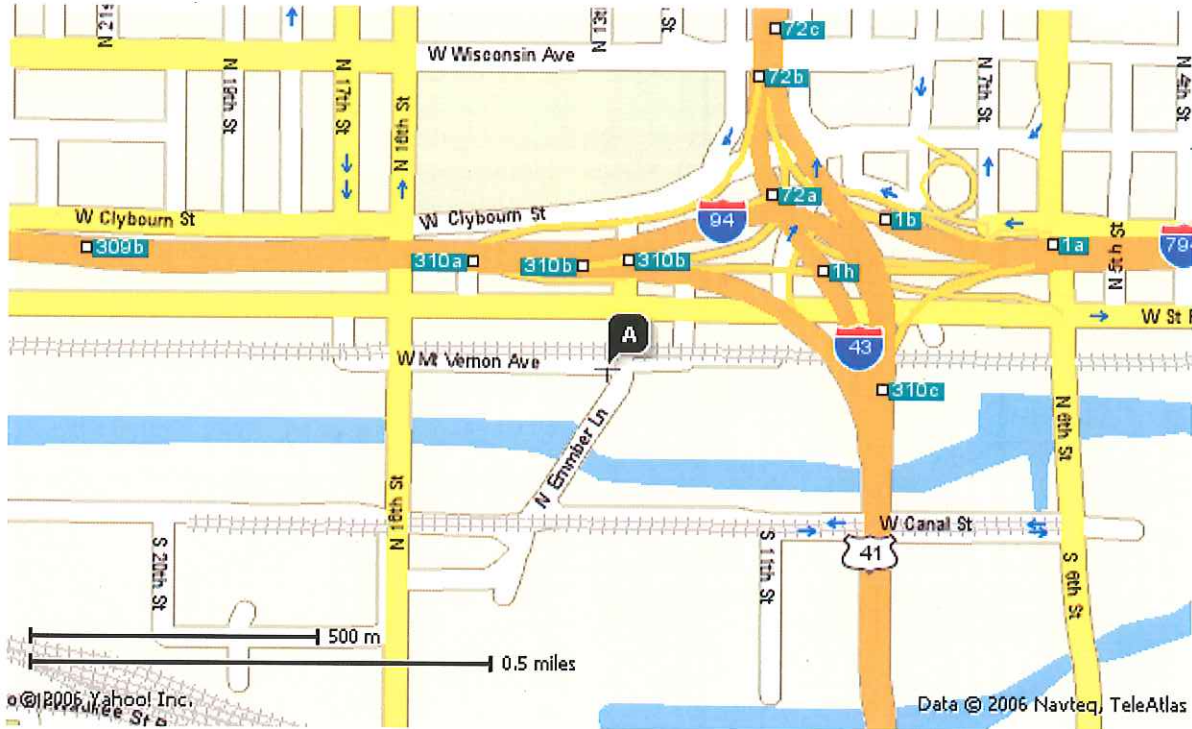

When using any driving directions or map, it's a good idea to do a reality check and make sure the road still exists, watch out for construction, and follow all traffic safety precautions. This is only to be used as an aid in planning.

