

Notice: This final report is authorized by ss. 281.65 and 281.66, Wis. Stats., and chs. NR 153 and NR 155, Wis. Adm. Code. Personally identifiable information collected will be used for program administration and may be made available to requesters as required under Wisconsin's Open Records Law [ss. 19.31-19.39, Wis. Stats.].

Instructions: The grant agreement requires grantees to submit a Final Report 60 days after the end date listed in the grant agreement. This Final Report form must be used in conjunction with the "FINAL REPORT INSTRUCTIONS." The instructions detail how to complete and submit the report to DNR.

1. Grant Type

- Agricultural - Targeted Runoff Management Grant
- Urban - Targeted Runoff Management Grant
- Construction - Urban Nonpoint Source & Storm Water Management Grant
- Planning - Urban Nonpoint Source & Storm Water Management Grant

2. Grantee & Project Information

Project Name COMPANY WOODS DRAINAGE CHANNEL	Grant Number TRM TUC-LF03-45241-02
Governmental Unit Name CITY OF KAUKAUNA	Governmental Unit Type (city, village, town, etc.) CITY
Watershed Name PLUM & KONKAPOT CREEK	Watershed Code LF03
DNR Water Management Unit (River System) Name FOX RIVER, LOWER SEGMENT 1	Water Body Identification Code (WBIC) (if applicable) 126800

s. 303(d) Waterbody? Yes No

What pollutant(s) were addressed by the project?

EROSION SEDIMENT AND SUSPENDED SOLIDS FROM URBANISED AREA.

For each project site location provide the following: (attach additional sheets if necessary)

Location:		A	B	C	D	E
Minor Civil Division Name		CITY				
PLSS	Town	21 N				
	Range	18 E				
	Section	21				
	Quarter	PART OF GOVERNMENT LOTS 2-6				
	Quarter-Quarter					
Latitude		N 44° 15' 59"				
Longitude		W 88° 15' 24"				
Property Owner(s)	Name	CITY OF KAUKAUNA				
	Mailing address	201 W. 2ND ST. KAUKAUNA, WI 54130				
Site address (if different than mailing address)		STARTS @ 1620 HILLCREST DRIVE KAUKAUNA, WI 54130				

3. Summary of Results

A. Performance Standards and Prohibitions and Other Water Resources Management Priorities

For grants issued in calendar year 2006 or later, complete Tables A and B (following) consistent with the entries on your grant application.
For grants issued prior to calendar year 2006, complete Tables A and B, *to the best of your knowledge*, consistent with the entries on your grant application.

Table A. Performance Standards and Prohibitions (per ch. NR 151, Wis. Adm. Code, effective October 1, 2002)

Performance Standard or Prohibition	Units of Measure	Quantity	Measurement Method Used
Sheet, rill and wind erosion	Acres meeting T		
Manure Storage Facilities: New Construction/Alterations	Number of facilities		
	Number of animal units		
Manure Storage Facilities: Closure	Number of facilities		
Manure Storage Facilities: Failing/Leaking Facilities	Number of facilities		
	Number of animal units		
Clean Water Diversions in WQMA	Pollutant load reduction		
	Number of farms with diversions		
	Number animal units		
Nutrient Management on Agricultural Land	Acres planned		
Prohibition: Manure Storage Overflow	Number of facilities		
	Number of animal units		
Prohibition: Unconfined Manure Pile in WQMA	Number of farms		
Prohibition: Direct Runoff From Feedlot/Stored Manure	Pollutant load reduction		
	Number of facilities		
	Number of animal units		
Prohibition: Unlimited Livestock Access	Feet of bank protected		
	Number of farms		
Urban: 20-40% Reduction in Total Suspended Solids (TSS)	Pounds TSS reduced		
	% TSS reduction		

Table B. Other Water Resources Management Priorities

I. Agricultural Areas	Units of Measure	Quantity	Measurement Method Used
Buffers	Feet of bank protected		
	Number of farms		
Streambank	Tons of bank erosion reduced		
	Feet of bank protected		
Other (specify)			
II. Developed Urban Areas	Units of Measure	Quantity	Measurement Method Used
Urban: 20-40% Reduction in TSS	Pounds TSS reduced		
	% TSS reduction	74%	PB
Infiltration	% Pre-development stay-on volume		
	Cubic feet stay-on volume		
Peak flow discharge	Change in cubic feet per second	40%	
Protective areas	Feet of bank protected		
Fueling & maintenance areas	Oily sheen presence		
Streambank	Tons of bank erosion reduced		
	Feet of bank protected	3000	
Other (specify)			
III. Planning	Units of Measure	Quantity	Measurement Method Used
Quantify how implementation of the planning project decreased storm water impacts on state waters (i.e., storm water plan, I & E plan, etc.)	Municipalities planned for		
	Acres planned for		
Document/track progress made in implementing the planning product (i.e., ordinance, utility district evaluation/formation, storm water management plan information & education, etc.)	Municipalities planned for		
	Acres planned for		
Other (specify)			

B. Project Results Narrative

THE CHANNEL HAS BEEN TRANSFORMED FROM AN ERODING CHANNEL INTO A WET DETENTION BASIN FOLLOWED BY A STONE LINED CHANNEL. WATER VELOCITY IN THE CHANNEL HAS BEEN REDUCED ALONG WITH TSS. REMOVAL OF 74% FROM A 47 ACRE URBANIZED AREA. THE SITE IS NOW USED BY THE 1000 ISLAND ENV. CENTER FOR STORM WATER EDUCATION.

4. Satisfaction of Notice Requirements (if applicable)

If cost sharing for this project was offered under a formal notice to achieve compliance with performance standards or prohibitions, provide information for each notice in the table below.

Notice Information				Notice Satisfaction Information		
Notice Type	Issue Date	From (Name)	To (Name)	Satisfied?		Date Letter Sent
				Yes	No	
				<input type="checkbox"/>	<input type="checkbox"/>	
				<input type="checkbox"/>	<input type="checkbox"/>	
				<input type="checkbox"/>	<input type="checkbox"/>	
				<input type="checkbox"/>	<input type="checkbox"/>	

5. Summary of Project Challenges

CHAPTER 30 PERMIT WAS DIFFICULT TO GET AND WAS NOT TIMELY. IN FACT, THE WATER MANAGEMENT SPECIALIST FOR AREA DECLINED TO ISSUE A PERMIT. LOBBYING HAD TO BE DONE TO GAIN APPROVAL (SEE ATTACHED LETTERS).

6. Additional Information about the Project (optional)

THE DNR GRANT PROGRAMS ARE GREATLY APPRECIATED AT THE LOCAL LEVEL. THEY ARE A SIGNIFICANT AID IN GETTING STORM WATER IMPROVEMENT PROJECTS COMPLETED.

7. Planning Product (UNPS&SW - Planning Projects only)

Check here if a printed copy of the planning product (e.g., plans, ordinances, analyses) was sent to your DNR Regional Nonpoint Source Coordinator.

Name of Document	Date(s) effective	Date Submitted to NPS Coordinator
------------------	-------------------	-----------------------------------

8. Grantee Certification:

Check here to certify that, to the best of your knowledge, the information contained in this report is correct and true.

Type or print Name and Title of Authorized Representative certifying here.

Date

JOHN SUNDELIUS

DIRECTOR OF PUBLIC WORKS

11/30/05

John W Sundelius



Kaukauna

ON THE FOX

December 27, 2002

1-14-02
- CALLED : LEFT
MESSAGE : CONCERNING
STATUS.

Mr. Jon Brand
Wisconsin Department of Natural Resources
1125 North Military Avenue
Green Bay, WI 54307

Dear Mr. Brand:

This letter is a follow up to our December 19, 2002, phone conversation. During that conversation, you expressed your concern regarding the appearance of the channel if it were to be lined with stone along the entire length. You also suggested some type of bioengineering to replace some of the stone lining.

I disagree with your conclusion that lining the entire channel is not an acceptable solution and offer the following in support of the original design. Armoring the entire channel with limestone riprap is necessary to prevent channel bed and bank erosion after project completion. The area has a dense canopy and ground cover vegetation simply cannot be supported due to the lack of sunlight. This condition is seen throughout this area of the conservancy as only leaf litter covers the bare soil. Channel erosion will continue in all areas, even after remediation, due to the "bare soil" conditions unless riprap is placed.

The original project design has received unanimous approval from all agencies involved until this point. The City of Kaukauna, owner of the property, obviously supports the original design. The 1000 Islands Environmental Center, charged with managing this conservancy area, stated in a May 1, 2001, letter (enclosed), that it "fully supports the project plan developed by the Outagamie County Land Conservation Department and the City of Kaukauna Engineering Department."

A thirty-day Public Notice required to allow the public to comment on the project, resulted in no comments. I also sent a memo to abutting property owners informing them of the project. No negative comments were received.

The Wisconsin Department of Natural Resources Bureau of Watershed Management, supports the original design as indicated through a letter dated August 28, 2002. Additionally, Targeted Runoff Management (TRM) program staff approve of the project to the level of providing significant grant assistance for its construction.

Finally, in support of complete channel lining, I have enclosed a photograph of a lined channel in Little Chute, Wisconsin. The channel is also in a wooded area and, in my opinion, blends in with its surroundings.



I believe we are incorporating measures to enhance the environmental attributes of this drainage corridor where possible. The creation of a wet detention area provides numerous benefits from sediment control to reducing peak flows. The detention area will also allow for the establishment of wetland vegetation where none exists now. The project introduces grasses to the area exposed by wet detention construction. Additionally, the 1000 Island Environmental Center will plant a variety of native tree species in the project area. Tree planting is an annual educational event at the Center.

Based on the above, I request that reconsideration be given to the original project design and that the necessary permit be issued.

Sincerely,

A handwritten signature in black ink, appearing to read "John W. Sundelius". The signature is written in a cursive, flowing style.

John W. Sundelius, P.E.
Deputy Director of Public Works

Enclosure

Cc: 1000 Islands Environmental Center
Bob Wilson, DATCP
Dennis Fritz, Outagamie County Land Conservation District







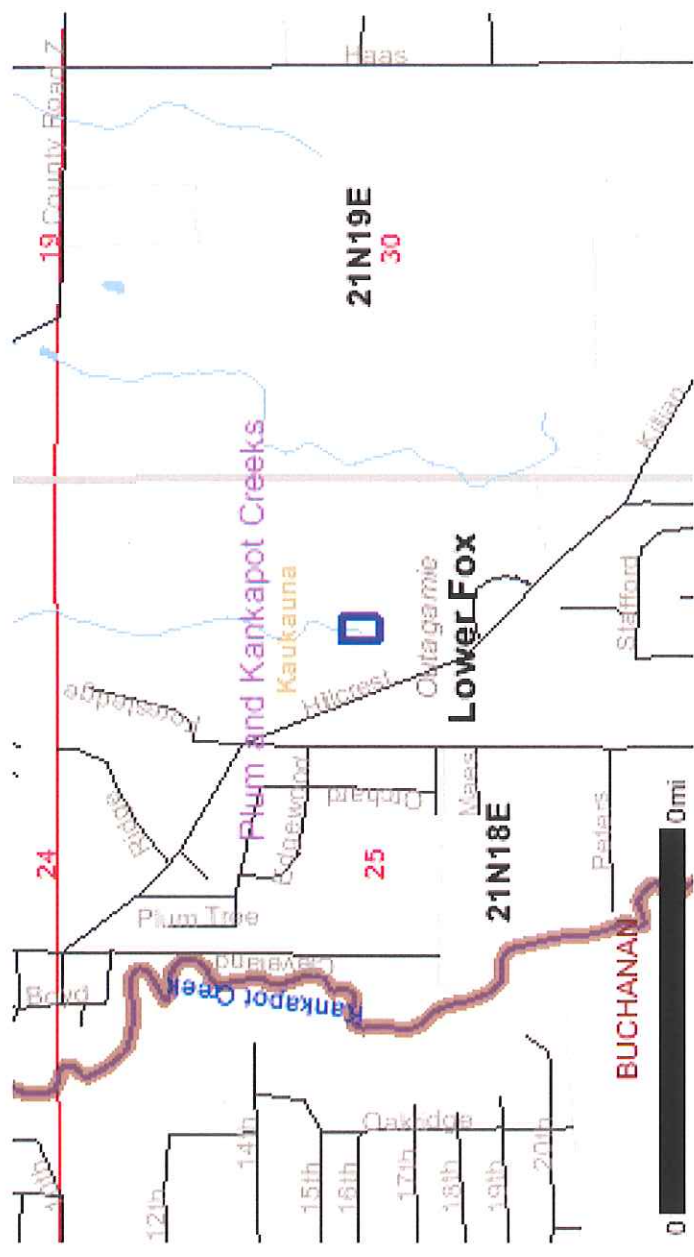

DETAILED WATERSHED MAP

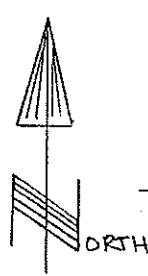
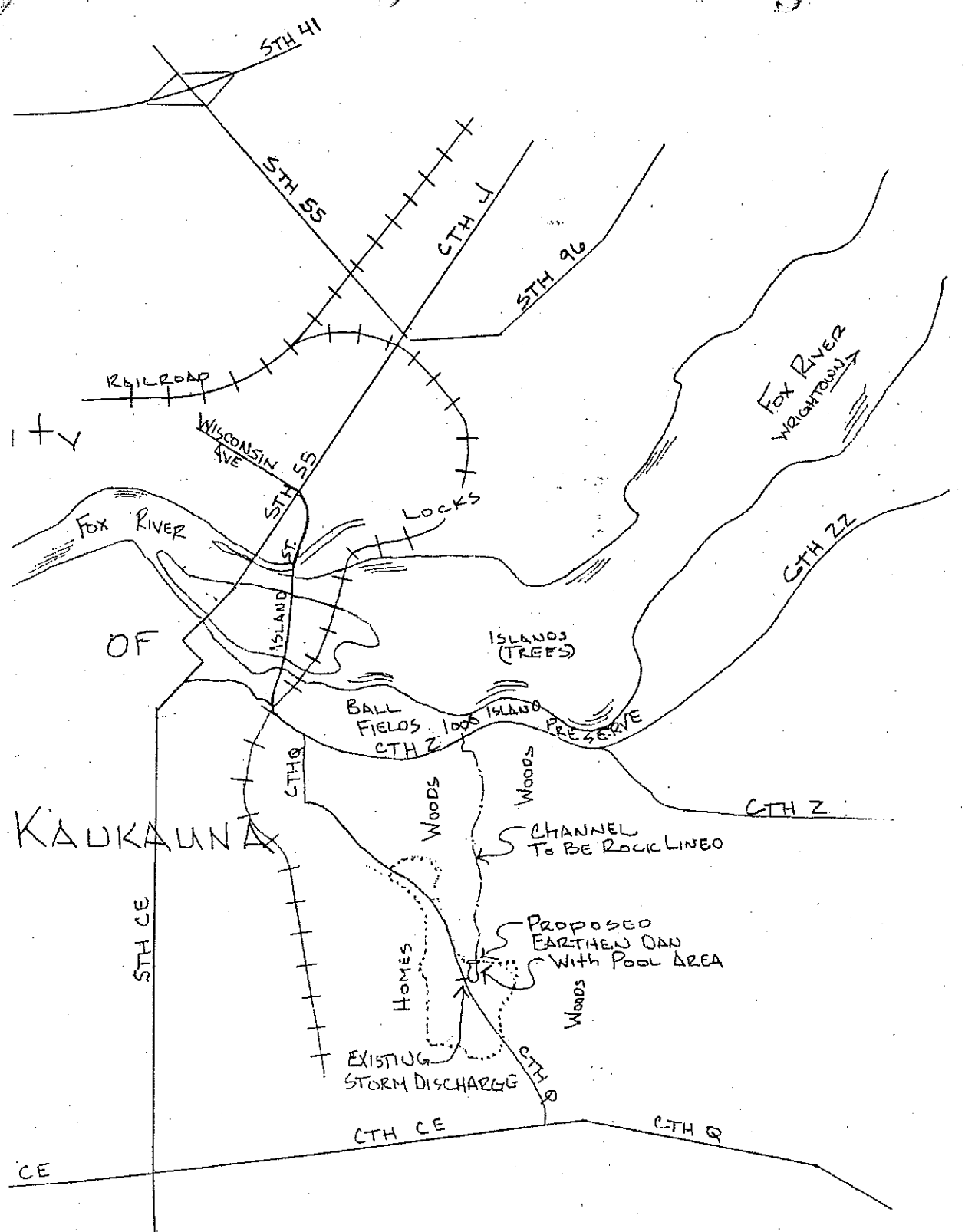

LOCATION MAP

Scale 1" = 2000'