

dnr.wi.gov

Notice: This final report is authorized by ss. 281.65 and 281.66, Wis. Stats., and chs. NR 153 and NR 155, Wis. Adm. Code. Personally identifiable information collected will be used for program administration and may be made available to requesters as required under Wisconsin's Open Records Law [ss. 19.31-19.39, Wis. Stats.].

Instructions: The grant agreement requires grantees to submit a Final Report 60 days after the end date listed in the grant agreement. This Final Report form must be used in conjunction with the "FINAL REPORT INSTRUCTIONS." The instructions detail how to complete and submit the report to DNR.

1. Grant Type

- Agricultural - Targeted Runoff Management Grant
- Urban - Targeted Runoff Management Grant
- Construction - Urban Nonpoint Source & Storm Water Management Grant
- Planning - Urban Nonpoint Source & Storm Water Management Grant

2. Grantee & Project Information

Project Name <b>Germ Valley North</b>	Grant Number <b>TRC-SP05-13000-05B</b>
Governmental Unit Name <b>Dane County LCD</b>	Governmental Unit Type (city, village, town, etc.) <b>County</b>
Watershed Name <b>Gordon Creek</b>	Watershed Code <b>SP05</b>
DNR Water Management Unit (River System) Name <b>Grant/Platte/Sugar/Pec.</b>	Water Body Identification Code (WBIC) (if applicable) <b>909200</b>

s. 303(d) Waterbody?     Yes     No

What pollutant(s) were addressed by the project? Streambank erosion, unconfined cattle access.

For each project site location provide the following: (attach additional sheets if necessary)

Location:		A	B	C	D	E
Minor Civil Division Name		<b>Blue Mounds</b>	<b>Blue Mounds</b>			
PLSS	Town	<b>6N</b>	<b>6N</b>			
	Range	<b>6N</b>	<b>6E</b>			
	Section	<b>28</b>	<b>32</b>			
	Quarter	<b>sw</b>	<b>ne</b>			
	Quarter-Quarter	<b>SW</b>	<b>NE</b>			
Latitude		<b>42° 57' 46.1" N</b>	<b>42° 57' 31.7" N</b>			
Longitude		<b>89° 47' 56.8" W</b>	<b>89° 48' 0.9" W</b>			
Property Owner(s)	Name	<b>Kahl</b>	<b>Holmes</b>			
	Mailing address					
Site address (if different than mailing address)						

3. Summary of Results

A. Performance Standards and Prohibitions and Other Water Resources Management Priorities

For grants issued in calendar year 2006 or later, complete Tables A and B (following) consistent with the entries on your grant application.  
For grants issued prior to calendar year 2006, complete Tables A and B, to the best of your knowledge, consistent with the entries on your grant application.

**Table A.** Performance Standards and Prohibitions (per ch. NR 151, Wis. Adm. Code, effective October 1, 2002)

Performance Standard or Prohibition	Units of Measure	Quantity	Measurement Method Used
Sheet, rill and wind erosion	Acres meeting T		
Manure Storage Facilities: New Construction/Alterations	Number of facilities		
	Number of animal units		
Manure Storage Facilities: Closure	Number of facilities		
Manure Storage Facilities: Failing/Leaking Facilities	Number of facilities		
	Number of animal units		
Clean Water Diversions in WQMA	Pollutant load reduction		
	Number of farms with diversions		
	Number animal units		
Nutrient Management on Agricultural Land	Acres planned		
Prohibition: Manure Storage Overflow	Number of facilities		
	Number of animal units		
Prohibition: Unconfined Manure Pile in WQMA	Number of farms		
Prohibition: Direct Runoff From Feedlot/Stored Manure	Pollutant load reduction		
	Number of facilities		
	Number of animal units		
Prohibition: Unlimited Livestock Access	Feet of bank protected	300	Ft. installed
	Number of farms		
Urban: 20-40% Reduction in Total Suspended Solids (TSS)	Pounds TSS reduced		
	% TSS reduction		

**Table B.** Other Water Resources Management Priorities

I. Agricultural Areas	Units of Measure	Quantity	Measurement Method Used
Buffers	Feet of bank protected		
	Number of farms		
Streambank	Tons of bank erosion reduced		
	Feet of bank protected	14,000	Ft. protected
Other (specify)			
II. Developed Urban Areas	Units of Measure	Quantity	Measurement Method Used
Urban: 20-40% Reduction in TSS	Pounds TSS reduced		
	% TSS reduction		
Infiltration	% Pre-development stay-on volume		
	Cubic feet stay-on volume		
Peak flow discharge	Change in cubic feet per second		
Protective areas	Feet of bank protected		
Fueling & maintenance areas	Oily sheen presence		
Streambank	Tons of bank erosion reduced		
	Feet of bank protected		
Other (specify)			
III. Planning	Units of Measure	Quantity	Measurement Method Used
Quantify how implementation of the planning project decreased storm water impacts on state waters (i.e., storm water plan, I & E plan, etc.)	Municipalities planned for		
	Acres planned for		
Document/track progress made in implementing the planning product (i.e., ordinance, utility district evaluation/formation, storm water management plan information & education, etc.)	Municipalities planned for		
	Acres planned for		
Other (specify)			

B. Project Results Narrative

Pls see memo to Kurt Welke dated 12/27/05

4. Satisfaction of Notice Requirements (if applicable)

If cost sharing for this project was offered under a formal notice to achieve compliance with performance standards or prohibitions, provide information for each notice in the table below.

Notice Information				Notice Satisfaction Information		
Notice Type	Issue Date	From (Name)	To (Name)	Satisfied?		Date Letter Sent
				Yes	No	
				<input type="checkbox"/>	<input type="checkbox"/>	
				<input type="checkbox"/>	<input type="checkbox"/>	
				<input type="checkbox"/>	<input type="checkbox"/>	
				<input type="checkbox"/>	<input type="checkbox"/>	

5. Summary of Project Challenges

Please see documentation for project substitution.

6. Additional Information about the Project (optional)

7. Planning Product (UNPS&SW - Planning Projects only)

Check here if a printed copy of the planning product (e.g., plans, ordinances, analyses) was sent to your DNR Regional Nonpoint Source Coordinator.

Name of Document	Date(s) effective	Date Submitted to NPS Coordinator

8. Grantee Certification:

Check here to certify that, to the best of your knowledge, the information contained in this report is correct and true.

Type or print Name and Title of Authorized Representative certifying here.

**Pete Jopke**

Signature of Authorized Representative	Date January 15, 2008
--	-----------------------

## Substitution Request Supporting Documentation for German Valley North 2005 TRM

The original proposal identified shaping, sloping and stabilization of streambanks to prevent erosion in highly grazed areas. The original application did not identify animal waste as a contributing pollutant. Since the submittal and subsequent award, a farm site has been identified as a source of manure to the stream.

Because of the operations location, there are limited options for mitigating this runoff threat. The proposed substitution would mitigate the animal waste threat as well as increase stream length and habitat by returning the stream to its original channel.

The following practices will be implemented at this site:

- 1) Stream relocation away from the farm site and back to its original channel
- 2) Shaping, sloping, and seeding of the new streambank including the addition of habitat structures
- 3) Creation of a grassed buffer area
- 4) Fencing
- 5) Waterway

A fish kill that occurred in the fall of 2004 was potentially linked to this site. Upon further investigation, it was determined that the landowner was not in compliance with requirements set forth in NR 151. If granted, this substitution request would bring the landowner into compliance with NR 151.

The total cost of the project would increase approximately \$5,000-\$7,000. This increase would be offset by Dane County declining to take the \$7,700 in staffing costs associated with project management and design. Instead, this money would be targeted for the increased costs of implementing the proposed alternative solution.

Total length of stream restoration and rehabilitation throughout the entire project area would decrease by approximately 15%. However, the project would add another benefit in that the projected annual phosphorus loading would be reduced from 557.9 pounds to 0 based on the BARNY model.



**DANE COUNTY  
CONSERVATION SERVICES DIVISION**

LYMAN F. ANDERSON AGRICULTURE & CONSERVATION CENTER  
1 Fen Oak Ct., Rm. 208, Madison, Wisconsin 53718-8812  
PH: 608/224-3730 • FAX: 608/224-3745  
[www.co.dane.wi.us/landconservation/](http://www.co.dane.wi.us/landconservation/)

Date: 12/27/05

To: Kurt Welke

From: Patrick J. Sutter  
Soil & Water Conservationist  
Dane County Land Conservation Department

Re: German Valley North, 2005 TRM Project, Final Report

Dane County Soil and Water Resources Department, Land Conservation Division (LCD) applied for and received fund through the DNR Targeted Resource Management (TRM) program in the spring of 2004 for the German Valley North project area. LCD was successful, receiving a state grant for \$140,880 to install conservation practices on this project. German Valley South was completed in 2004 and German Valley North was completed in the fall of 2005. The north project is located in Blue Mounds Townships, Dane County and runs approximately 1.3 miles in sections 28 and 33. Lands owned by John Kahl and William Holmes.

A local work group comprised of LCD, DNR, landowners and operators, Upper Sugar River Watershed Association (USRWA), and Trout Unlimited (Southern Wisconsin Chapter) leaders helped developed a management plan to detail the goals and objectives of this project. Streambank protection and fish habitat restoration was prioritized on the stream system. The LCD and DNR fish management staff provided the administration and technical support for the project installation.

The following organizations provided in-kind labor and funds used as match to the \$136,271.10 TRM grant, including: TU (\$10,700.00 in-kind labor), USRWA (\$10,700.00 in-kind labor), Dane County Soil & Water Resource Department (\$25,000.00). The main source for in-kind labor comes from the construction of 127 LUNKER structures. TU receive a 20-year, 33-foot-wide easement on the project area for public access. Total estimated length of stream restoration is 1.3 miles.

The construction portion of this project started the first week in September and was completed by Mid November 2005. Practices were installed on two different properties, which include 54 riprap weirs, 14,000 feet of shaping and seeding, 127 fish habitat structures, 1 acre wastewater treatment strip, 1 acre grassed waterway, 1'500 feet of fencing, 300' concrete livestock crossing, and 11 acres of critical area seeding.

# Conservation Plan Map

**Owner: Marc Rhiner**  
**Operator:**

**Township(s): Primrose**  
**Section(s): 4, 5 & 9**  
**Tract(s): 13830**

**Completed by: Pat Sutter**  
**Phone: (608) 224-3730**  
**Date: 1/04/06**

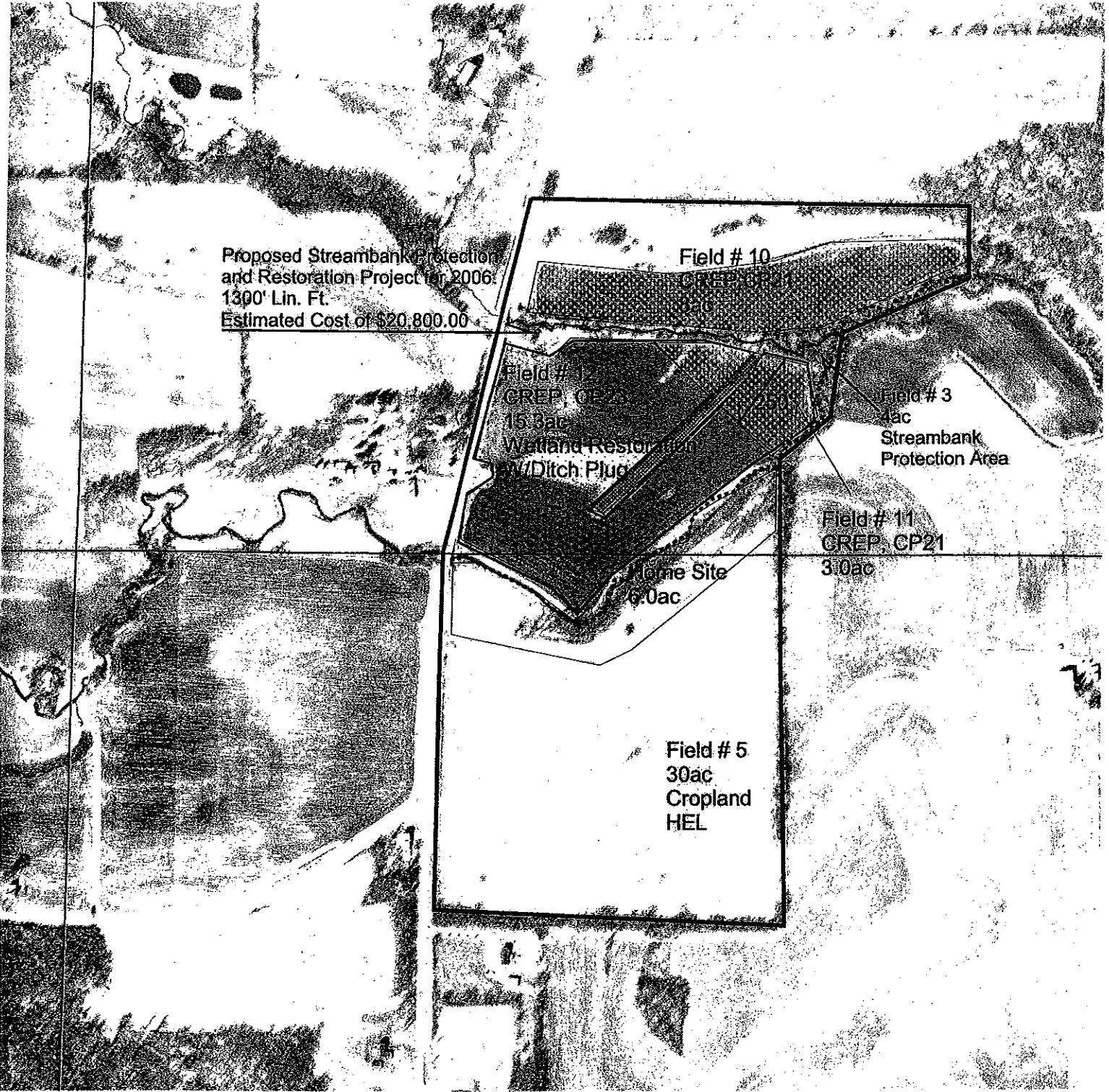

# MAP - 2

German Valley Watershed  
Location - Blue Mounds, 6N-6E, Sections - 31 & 32  
Perry, 5N-6E, Section - 6  
Watershed Acres - 6482.0

Mt Horeb

HWY E

HWY 18-151

2007 TRM  
Project Area

Streambank Protection  
and Habitat Restoration  
Project Area  
- 12,000' of Stream  
- 6ac of Corned (native seeding)  
- 5 Landowners

HWY 78 S

2005 TRM Project  
Area

2004 TRM PROJECT AREA

Blue Mounds Twn

Perry Twn

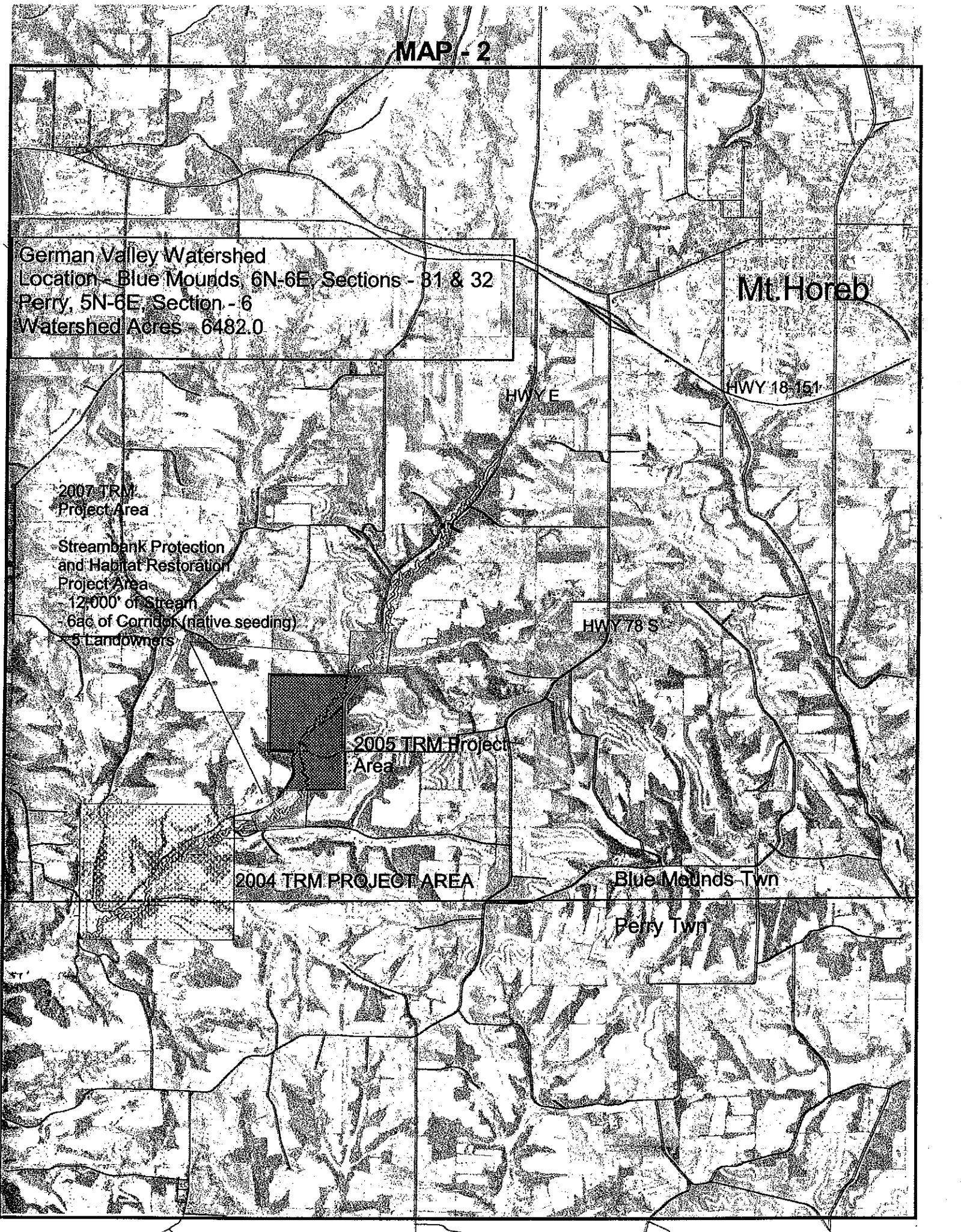

# Streambank Protection & Habitat Restoration Project Plan Map 2007 TRM Project

Owner: Chuck Learned &  
Linda Farmer &  
Charles Van Valkenburg

Township(s): Blue Mounds  
Section(s): 28

Completed by: Pat Sutter  
Phone: (608) 224-3730  
Date: 1/09/2006

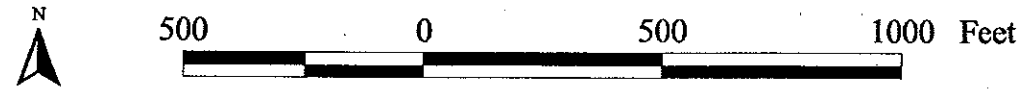



# Streambank Protection & Habitat Restoration Project Plan Map 2007 TRM Project

Owner: Larry Haas &  
Larry Thompson

Township(s): Blue Mounds  
Section(s): 28

Completed by: Pat Sutter  
Phone: (608) 224-3730  
Date: 1/09/2006

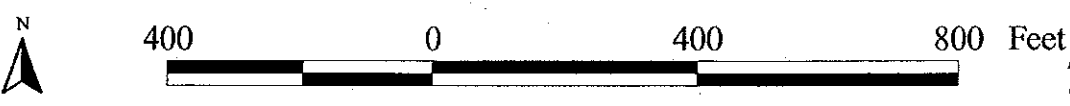
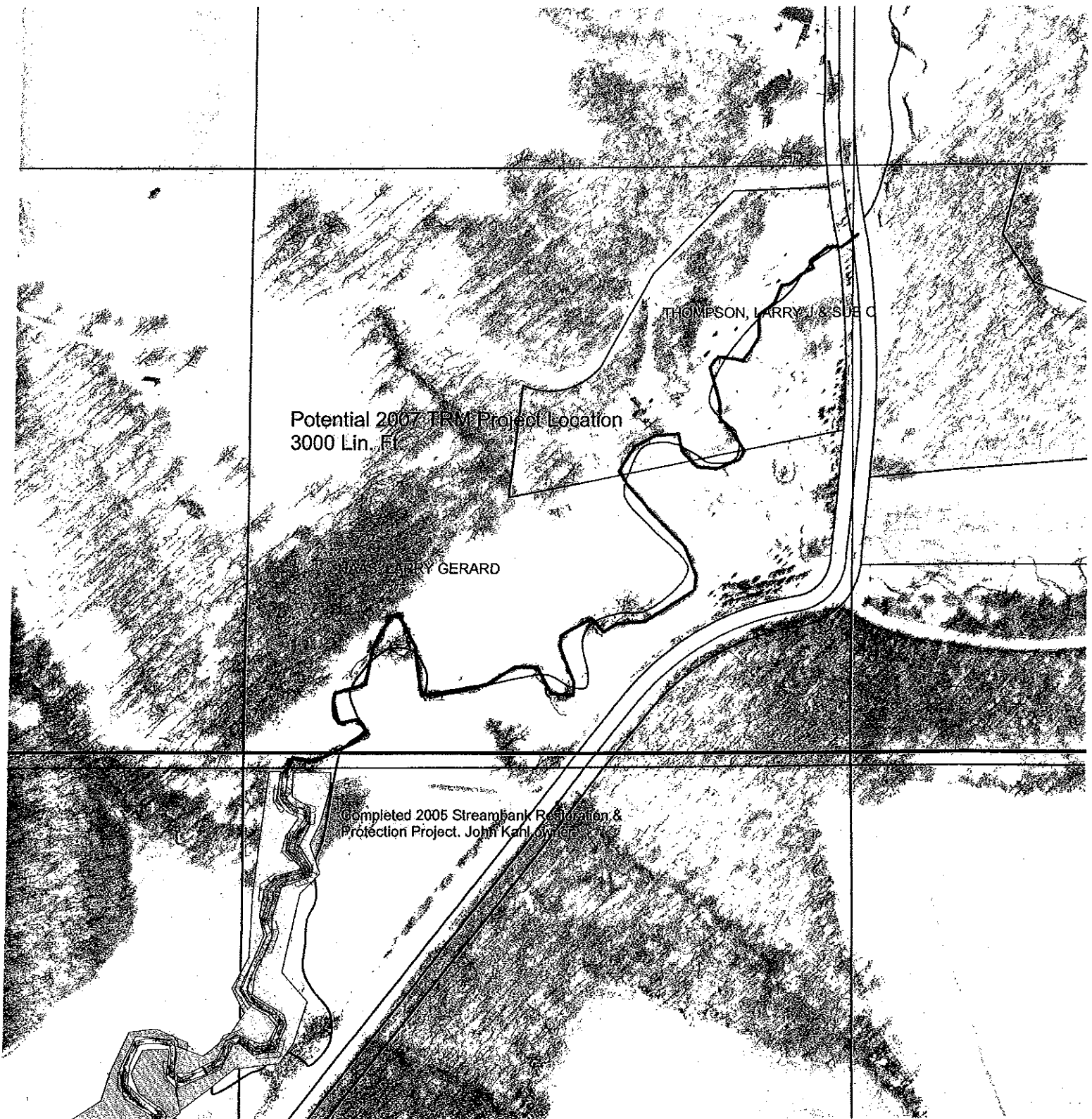

# Dane Cnty-German Valley N-2005 B\_Sep 10, 2008

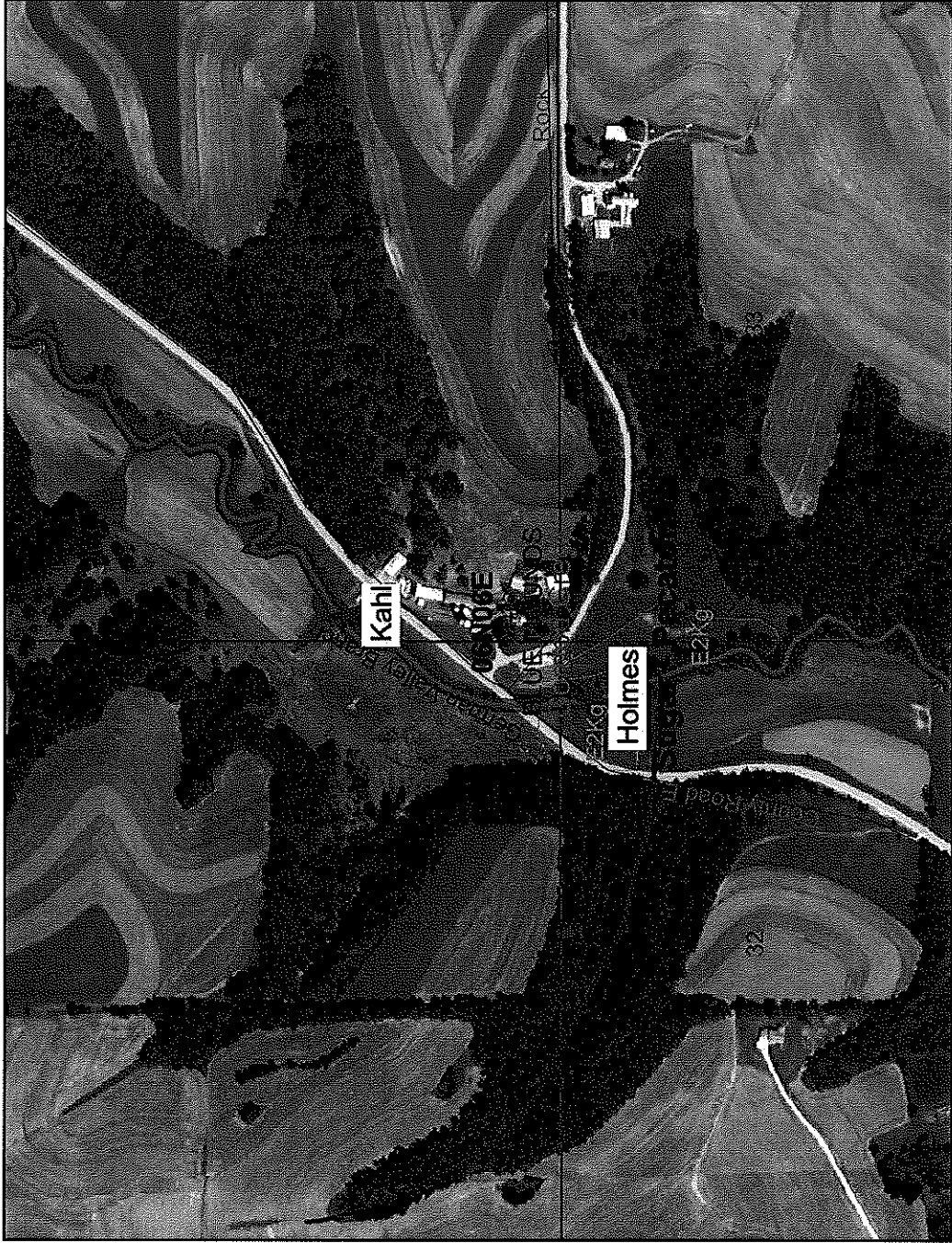

This map is a user generated static output from an Internet mapping site and is for general reference only. Data layers that appear on this map may or may not be accurate, current, or otherwise reliable. THIS MAP IS NOT TO BE USED FOR NAVIGATION.



## Legend

- Railroads
- Local Roads
- NR104 Lines
- Outstanding and Exceptional Waters
- Exceptional Outstanding
- PRF Sensitive Areas of Lakes
- ASNRI Outstanding and Exceptional Streams
- ORW
- ORW
- ORW
- ASNRI Outstanding and Exceptional Lakes
- ERW
- ERW
- ERW
- ASNRI Wild and Scenic Rivers
- ASNRI Trout Streams
- Class I Trout
- Class II Trout
- Class III Trout
- ASNRI Wild Rice Streams
- ASNRI Wild Rice Areas
- ASNRI Quality Wetland Streams
- ASNRI Quality Wetland Areas
- ASNRI NHI Streams
- ASNRI NHI Areas
- PINW Musky Streams



Scale: 1:7,299





